

Datasheet

Product Name : Zigbee Bridge

Model No. : ZD-806P

Release Date : 2020-09-08

Document version.

2018/03/02 Ver. 1.0
2019/05/12 Ver 1.1
2020/09/08 Ver 1.2

Approved	Audit	Design

1 Functions

ZD-806 is a powerful, special designed Zigbee bridge, it just like a bridge, which offer more connectivity ability with other input signal, even RS232 programming interface. Allow other system or contact to control or trigger lamp controller with ECO-Link pro system, Becomes a real open system. ZD-806 offer: 0-10V/1-10V input (Notice: dimmer with resistor only but w/o output current is not suitable)) , DALI input, RS232 input, Dry contact input,, AC L/N line signal input, 5 kinds of interface can work simultaneously.

You can connect such as machine relay, PC program, other 0-10V or DALI dimming system and trigger lamp action via detecting AC circuit status.

It connect with ECO-Link Pro gateway, and easy to link the interface with lamp group via cellphone app.

2 Infrastructure

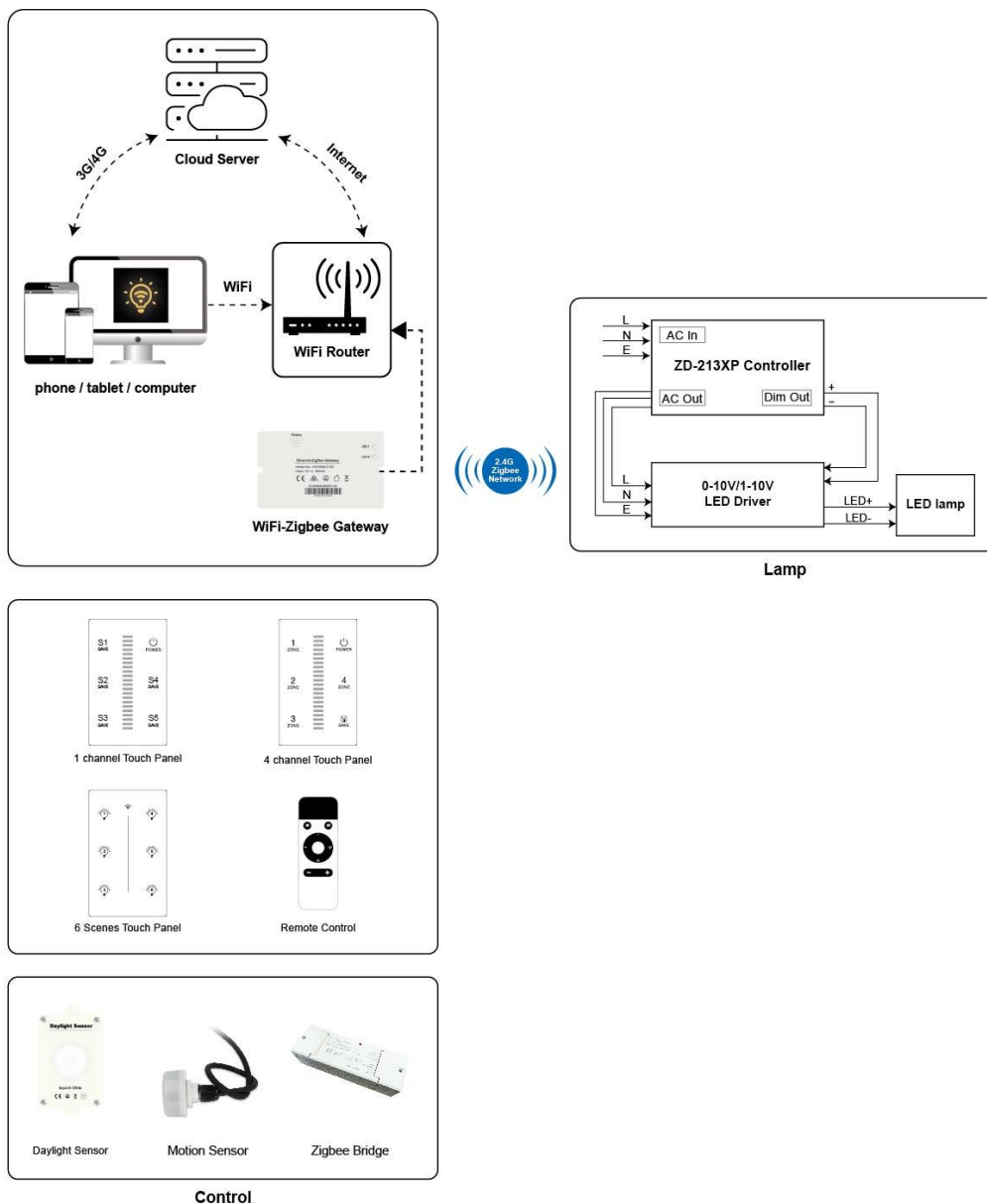



Product photo

(1) Connection description :

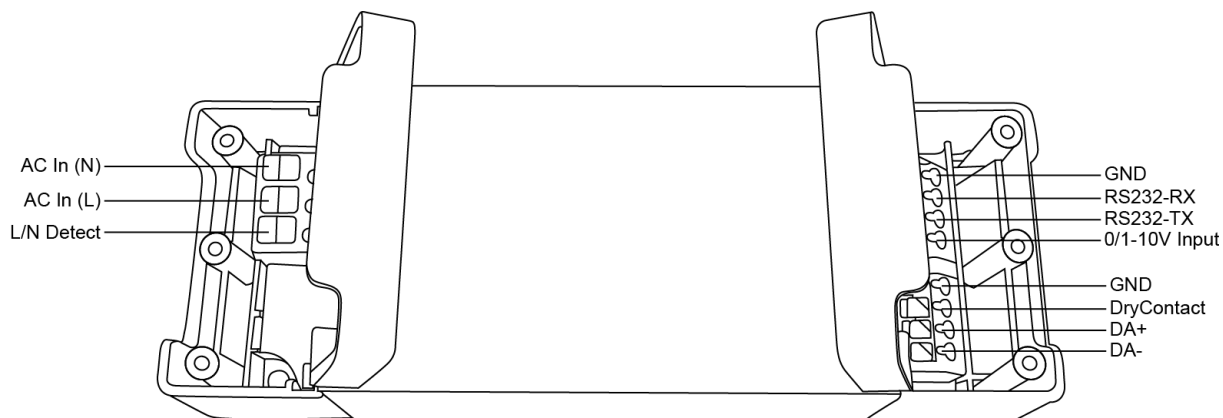

3 Input interface

(1) Definition :

Ports		Description
Input	AC/L	AC 100-277V 50/60Hz, Power input.
	AC/N	
	L/N Detect	L or N line of the AC 100-277V 50/60Hz input (connect the AC circuit in parallel), for example, you can detect AC ON/OFF switch, to realize lamp control via traditional machine switch or button.
	0~10V Input	For example: connect 0-10V dimmer switch, to dim the lamp, or connect with other 0-10V dimming system.
	Dry Contact	The dry contact is able to connect : such as alarm system.
	GND	The GND for the Dry contact.
	DA+	DALI + and - signal input, to connect with other DALI system , let other DALI system control the lamp in the ECO-Link pro system. (DALI address is not provided, need a standalone DALI cable)
	DA-	
	GND	(Beside RS232 port), The GND for RS232 and 0-10V – negative end.
	RS232-RX	RS232 RX (Receiving)
	RS232-TX	RS232 TX (Sending)

(2) RS232 protocol example : (Please see newest protocol)

ASCII code	Description
ON	Lamp on and 100% brightness.
OFF	Lamp Off
DIM+	Dim up +1 (10%)
DIM-	Dim down -1 (10%)
DIMxx	Dim the lamp to designate brightness (xx= percentage. DIM70= dim to 70%)
CT+	Adjust the lamp CCT up +1 level (10%)
CT-	Adjust the lamp CCT up -1level (10%)
CTXX	Adjust the lamp CCT to designate percentage (for example: CT50=adjust lamp CCT to mixed 50%)

*RS232 port settings: (9600,N,8,1) Baud rate: 9600, Parity: None, Data bits: 8, Stop bit: 1

(3) How to use the bridge?

The principle of the Zigbee Bridge is let other signal or system is able to control the lamps in the ECO-Link Pro, what you need to do is add the Zigbee Bridge into the gateway just like other Zigbee device. And setup the linked lamp group with the bridge via App. Different interface performs different control ability, described as below:

Interface	Descriptions
L/N Detect	Detect the AC circuit status via L or N line. When AC circuit ON or OFF is detected, the lamp group pre-linked with the bridge will be activated to ON or OFF (no dimming)
0-10V/1-10V Input	This interface allow 0-10V 或 1-10V dimming signal input. So it performs dimming action for the linked lamp group.
Dry Contact	To connect a circuit (w/o voltage or current). When the dry contact is short-circuit, the lamp group linked with the bridge will turn ON or dim up to 100% . and when the dry contact is off circuit, the lamp group turn OFF (no dimming)
DALI	Allow DALI dimming signal input. Accept DALI dimming command to dim the lamp group. # There is no DALI address, so this require a proprietary DALI cable.
RS232	RS232 Communication port. ECO-Link Pro provides TEXT command, allow other system to control lamp via program. It offers rich controlling ability, such as ON/OFF, dimming, CT twin color controlling and is able to control a designate group in the command text.

You can connect all of the interface simultaneously, the bridge always accept last command. One bridge is allow to connect one group of lamp (despite RS232, it allows control multiple group in one bridge), you can add more zigbee bridge if you need to connect more lamp groups for different activity.

- Zigbee Bridge does not support RGB/RGBW controlling.
- The Antenna of the Zigbee bridge is built in, do not put the device in the sealed metal box, the signal is difficult to send through metal barrier.

(4) Wiring

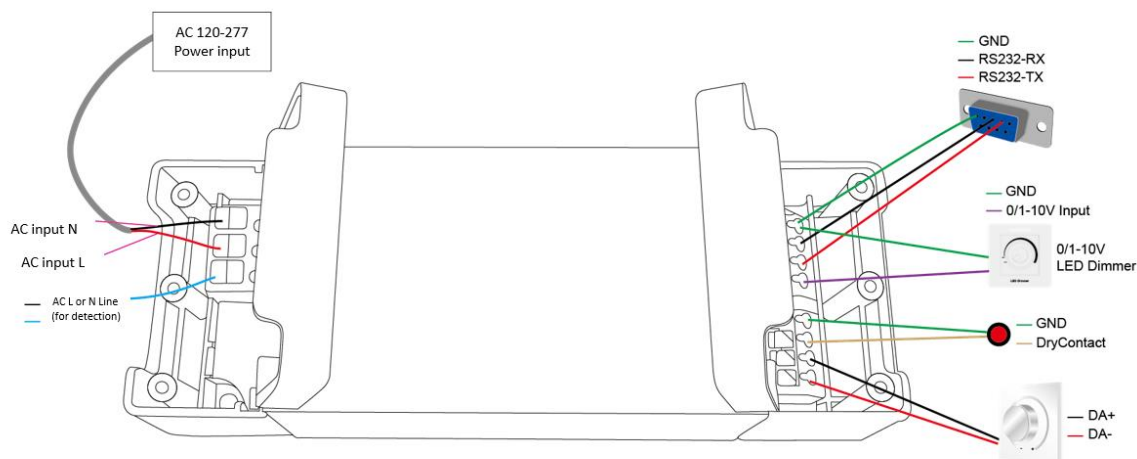

4 Parameters

Param.	Description
Input Voltage	100~277Vac 50/60Hz
Output voltage	100~277Vac 50/60Hz
Wireless Frequency	2.4GHz
Working Temp.	-40°C ~ 80°C
Max. Transmit Distance	30m (Open space)
Idle Wattage Consumption	<=0.2W

5 Dimensions

140x50x30mm

6 Weight

100g

7 Package

1pcs/Box